

EXECUTIVE SUMMARY

POTENTIAL COMMONWEALTH ACQUISITION PROPERTY SUMMARY

Property Name (Identifier): 32 Atlin Lane, Jonestown, PA. 17038



Marketing Area: Jonestown / FTIG	Current Listing/Asking Price: N/A – Donation Due diligence actions and closing costs only
County: Lebanon	Tax Parcel ID(S): 33-2289035-408516-0000
Township: Union Township	Zoning: Open Space – Timber Conservation Comment: The current residential use is in compliance with zoning regulations.
Address of Public Record: 32 Atlin Lane, Jonestown, PA.	
Acreage: Total of 12.66 Acres	Age of Improvements: Built in 1977. 42 years.
Owner(s): Ward Burton Wildlife Foundation	Public Utilities Available: Electric On-site well & Septic system (common to area)
Improvements: The property consists of a 12.66 acre mostly wooded parcel that contains a 1388 sq.ft. 1.5 story contemporary styled dwelling built in 1977 that appears to be of average quality. The above grade levels contains 4 total rooms, 2 bedrooms and two full baths. The basement has been partially finished into a recreation room. There is also a large detached 2-car garage with loft.	
Additional Site Characteristics: The subject property is in Union Township just off Route 443 / Moonshine Road near the Moonshine United Zion Church. It is part of a small enclave of privately-owned parcels that are completely surrounded by Commonwealth of PA owned Fort Indiantown Gap. The site is almost entirely made up of woodland with a small cleared homesite area. The deed references a 20' wide access right of way for the use of the two adjacent residential parcels; which coincidentally, are in the process of having a legal agreement of sale drafted with the intent of a DMVA/OFE/commonwealth purchase of the two parcels which total 21.34 acres.	

PROPERTY LOCATION

SUBJECT LOCATION

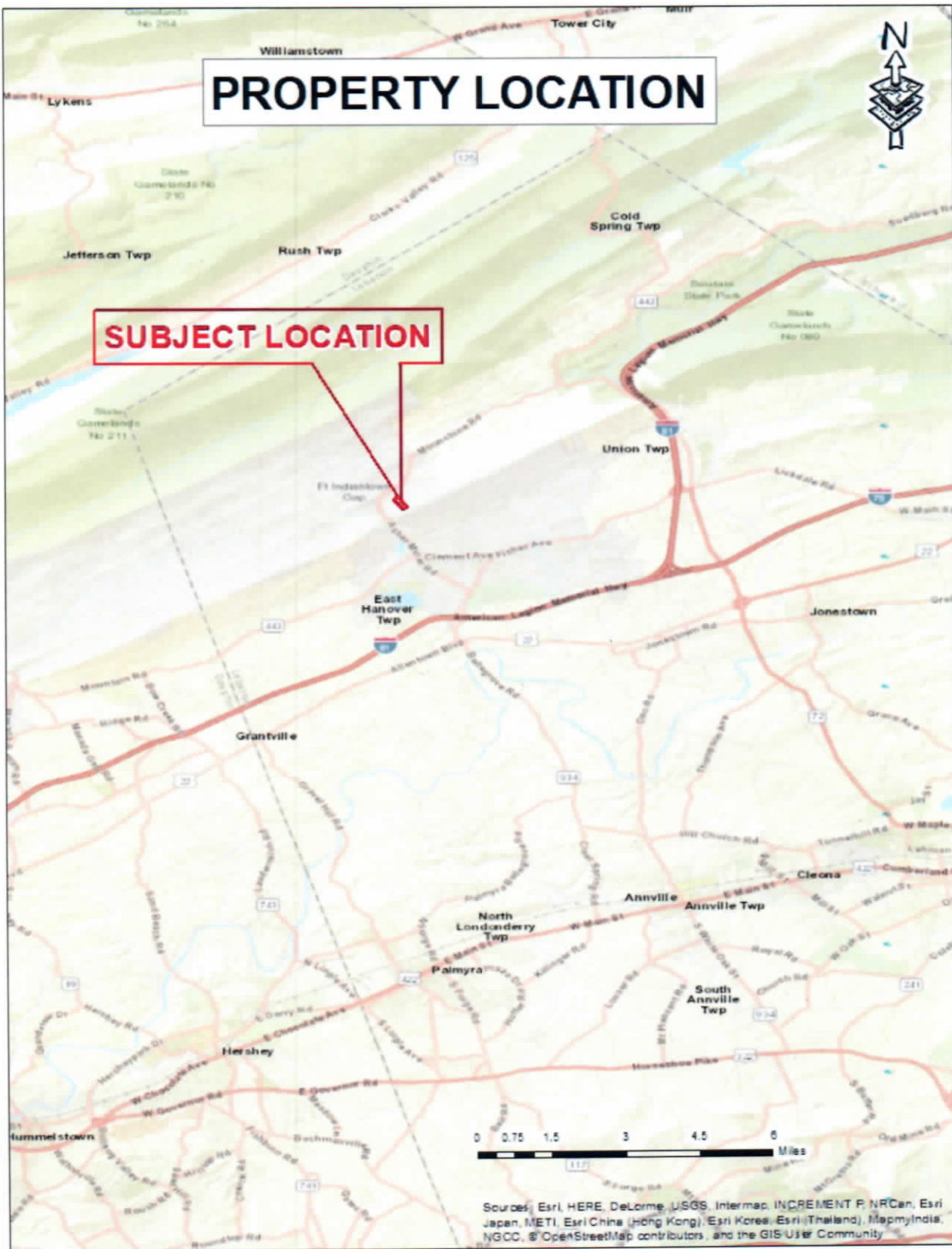

Sources: Esri, HERE, DeLorme, USGS, Intermap, INCREMENT P, NRCan, Esri Japan, METI, Esri China (Hong Kong), Esri Korea, Esri (Thailand), MapmyIndia, NGCC, OpenStreetMap contributors, and the GIS User Community

Aerial Map

**Red Polygon delineates
approximate property boundary**

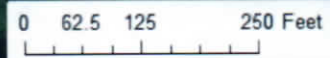

Sources: Esri, DigitalGlobe, GeoEye, Earthstar Geographics, CNES/Airbus DS, USDA, USGS, AeroGRID, IGN, and the GIS User Community